

ROOFROCK 30 E

Tooteinfo

Kivivillast soojustusplaat lamekatusele
 Toote tähistuskood:
 MW-EN 13162-T4-DS(70,90)-CS(10)30-WS-WL(P)-MU1
 Sertifikaat: 1390-CPR-0168/09/P; 1390-CPR-097/08/P;
 1390-CPR-0452/16/P

Tehnilised andmed

- Soojusjuhtivustegur: $\lambda_D = 0,036 \text{ W/m}\cdot\text{K}$
- Lühiajaline veeimavus: $\leq 1,0 \text{ kg/m}^2$
- Pikaajaline veeimavus: $\leq 3,0 \text{ kg/m}^2$
- Toodete tuletundlikkuse klass: **A1**
- Veeauru läbilaskvus: $\mu = 1$
- Survetugevus 10% deformatsiooni korral: $\geq 30 \text{ kPa}$



Toote kasutamine

ROOFROCK 30 E kivivillaplaate kasutatakse lamekatuste mitmekihilise isolatsiooni põhisoojustuskihina.

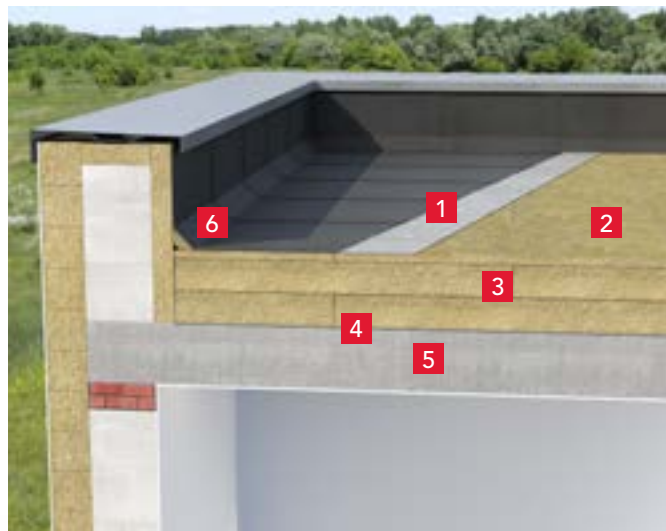

- 1 Katuse rullkate
- 2 ROOFROCK 50
- 3 **ROOFROCK 30 E**
- 4 Aurutõke
- 5 Betoonplaat
- 6 ROCKFALL KD kolmnurkne katuseelement

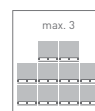
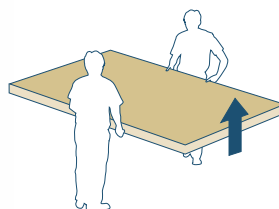

| Pikkus [mm] | Laius [mm] | Paksus [mm] | Toote kood | Soojus-akistus R_D | Kogus alusel | |
|----------------|---------------|----------------|---------------|--|-----------------|------------------|
| | | | | [$\text{m}^2\cdot\text{K}/\text{W}$] | [tk] | [m^2] |
| 2020 | 1220 | 50 | 325284 | 1,35 | 24 | 59,145 |
| 2020 | 1220 | 60 | 325285 | 1,65 | 20 | 49,288 |
| 2020 | 1220 | 70 | 325286 | 1,9 | 16 | 39,43 |
| 2020 | 1220 | 80 | 325287 | 2,2 | 15 | 36,966 |
| 2020 | 1220 | 100 | 325289 | 2,75 | 12 | 29,572 |
| 2020 | 1220 | 120 | 325291 | 3,3 | 10 | 24,644 |
| 2020 | 1220 | 140 | 325293 | 3,85 | 8 | 19,715 |
| 2020 | 1220 | 150 | 325294 | 4,15 | 8 | 19,715 |
| 2020 | 1220 | 160 | 325295 | 4,4 | 7 | 17,25 |
| 2020 | 1220 | 180 | 325297 | 5 | 6 | 14,786 |
| 2020 | 1220 | 190 | 325298 | 5,25 | 6 | 14,786 |
| 2020 | 1220 | 200 | 325299 | 5,55 | 6 | 14,786 |

Aluse mõõdud 2020 x 1220 x 1380 mm.